

# All in one... our LED Spotlight connectors



LED - light- and connection technology

**LED-C-LINE**

Spotlight connectors for COBs from **TRIDONIC**

With integrated reflector interface



Your Connection to Light

## The Advantages at a glance

- Compatible to standardised spotlight moduls as to hole pattern and external diameter
- Serviceable – easy exchange of LED board
- High light efficiency by the use of high reflective material
- Two defined reflector interfaces for metal or plastic reflectors

# COB assembly made easy



**Inverse-polarity protection**  
The polarity is clearly visible from the outside, also with the COB inserted

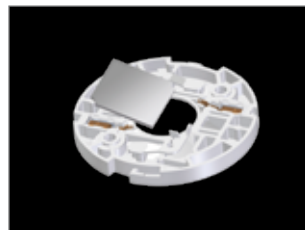

**Pre-centring:**  
Slide the COB...



**Pre-centering:**  
...between the flexible COB holders.



**Secure Fixation**  
The COBs are securely hold in place during the assembly process

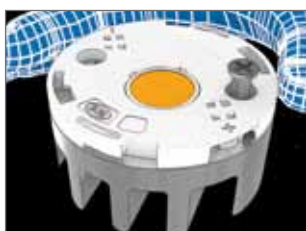

**Zhaga hole pattern**  
Fixation via standard screws and locking washers

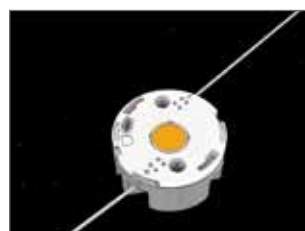

**Solder free connection**  
Using push wire terminals. Wiring can be arranged to one side.







**Internal reflector interface**  
For plastic and metal reflectors



**Insert, Twist, Done**  
Simple fixation via Twist & Lock

# Overview of different prefixation types

Light source	Connector	Features
SLE G5 LES 6, 10 & 11 (13.5 x 13.5 x 0.9 mm)	BJB 47.319.6060	Fixing elements, 0.5 mm <sup>2</sup> 
	BJB 47.319.5060	Fixing elements, 0.75 mm <sup>2</sup> 
SLE G5 LES 15 (19 x 19 x 0.9 mm)	BJB 47.319.2025	COB holders, 0.5 mm <sup>2</sup> 
	BJB 47.319.2026	COB holders, 0.75 mm <sup>2</sup> 
SLE G5 LES 17 (21 x 21 x 0.9 mm)	N/A	---
SLE G5 LES 19/23 (31 x 31 x 0.9 mm)	N/A	---



			pkg.	wt.	part no.
			504	3 g	47.319.6060.50

**With integrated reflector interface**  
**Easy pre-assembly by LED fixing lugs**  
 Screw fixing  
 Housing: PBT  
 Contacts: CuSn  
 Rating: 3A / 150 VDC  
 Approval: additional cULus

- Screw fixing: for screws M3 and locking washer
- Max. torque for screw fixing 0.5 Nm
- Strip length: 6+1 mm
- Polarity of LED must be observed
- Specifications of LED manufacturer must be observed
- VDE-Reg. No. E289

LED-LINE	T 110				CAD	i
		0.5 mm <sup>2</sup>	0.5 mm <sup>2</sup>			[06] 3...

			pkg.	wt.	part no.
			504	3 g	47.319.5060.50

**With integrated reflector interface**  
**Easy pre-assembly by LED fixing lugs**  
 Screw fixing  
 Housing: PBT  
 Contacts: CuSn  
 Rating: 3A / 150 VDC  
 Approval: additional cULus

- Screw fixing: for screws M3 and locking washer
- Max. torque for screw fixing 0.5 Nm
- Strip length: 6+1 mm
- Polarity of LED must be observed
- Specifications of LED manufacturer must be observed
- VDE-Reg. No. E289

LED-LINE	T 110				CAD	i
		0.75 mm <sup>2</sup>	0.75 mm <sup>2</sup>			[06] 3...

			pkg.	wt.	part no.
			420	5 g	47.319.2025.50

**With integrated reflector interface**  
**Easy pre-assembly by LED fixing lugs**  
 Screw fixing  
 Housing: PBT  
 Contacts: CuSn  
 Rating: 3A / 150 VDC  
 Approval: additional cULus

- Screw fixing: for screws M3 and locking washer
- Max. torque for screw fixing 0.5 Nm
- Strip length: 6+1 mm
- Polarity of LED must be observed
- Specifications of LED manufacturer must be observed
- VDE-Reg. No. E289

LED-LINE	T 110				CAD	i
		0.5 mm <sup>2</sup>	0.5 mm <sup>2</sup>			[06] 3...

## LED - Lighting and connection technology

47.319

Spotlight connectors for COB LED modules from Tridonic



pkg. wt. part no.  
420 5 g **47.319.2026.50**

**With integrated reflector interface**  
**Easy pre-assembly by LED fixing lugs**

Screw fixing

Housing: PBT

Contacts: CuSn

Rating: 3A / 150 VDC

Approval: additional cULus

- Screw fixing: for screws M3 and locking washer
- Max. torque for screw fixing 0.5 Nm
- Strip length: 6+1 mm
- Polarity of LED must be observed
- Specifications of LED manufacturer must be observed
- VDE-Reg. No. E289

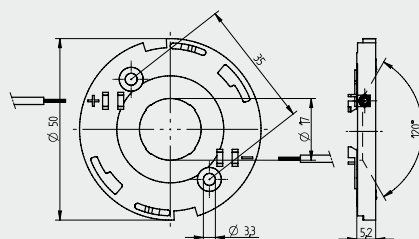

LED-LINE	T 110		0.75 mm <sup>2</sup>	0.75 mm <sup>2</sup>	CAD	i
[06] 3...						



pkg.	wt.	part no.
1	8 g	<b>47.940.-311.56</b>

### Reflector

For use with Spotlight connectors 47.319.6060, 47.319.6101, 47.319.6200 and 47.319.6180

Beam angle characteristic: Flood

- Reflector can only be used by screw fixing the spotlight connector with dome headed screws and locking washer

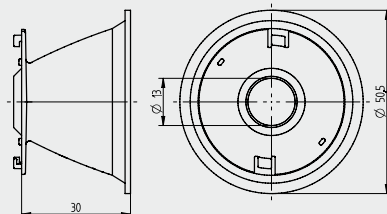

CAD i

[06] 3...

pkg.	wt.	part no.
1	8 g	<b>47.940.-312.56</b>

### Reflector

For use with Spotlight connectors 47.319.6060, 47.319.6101, 47.319.6200 and 47.319.6180

Beam angle characteristic: Medium

- Reflector can only be used by screw fixing the spotlight connector with dome headed screws and locking washer

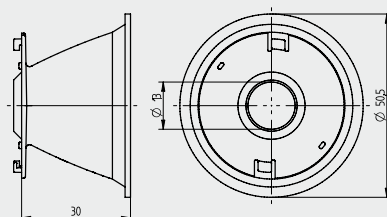

CAD i

[06] 3...

pkg.	wt.	part no.
1	8 g	<b>47.940.-313.56</b>

### Reflector

For use with Spotlight connectors 47.319.6060, 47.319.6101, 47.319.6200 and 47.319.6180

Beam angle characteristic: Spot

- Reflector can only be used by screw fixing the spotlight connector with dome headed screws and locking washer

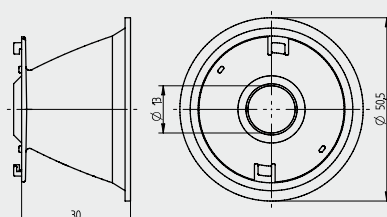

CAD i

[06] 3...

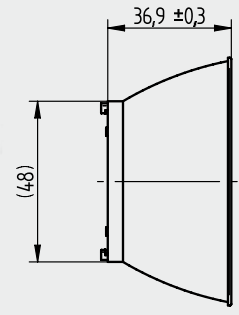
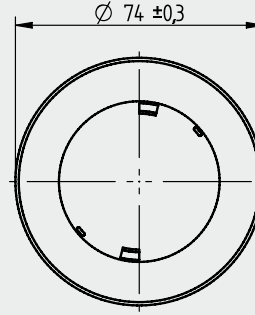

			pkg.	wt.	part no.
			1	8 g	<b>47.950.-301.56</b>

**Reflector**  
 For use with Spotlight connectors 47.319.2xxx and Spot-, Downlight modules 32.120.xxxx  
 Beam angle characteristic: Spot

- Reflector can only be used by screw fixing the spotlight connector with dome headed screws and locking washer

CAD

i  
[06] 3...

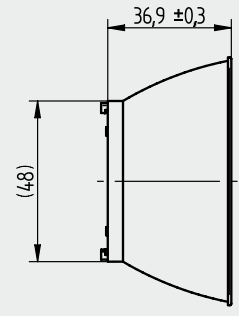
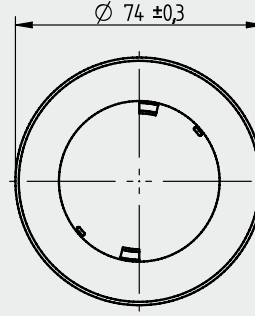
			pkg.	wt.	part no.
			1	8 g	<b>47.950.-302.56</b>

**Reflector**  
 For use with Spotlight connectors 47.319.2xxx and Spot-, Downlight modules 32.120.xxxx  
 Beam angle characteristic: Medium

- Reflector can only be used by screw fixing the spotlight connector with dome headed screws and locking washer

CAD

i  
[06] 3...

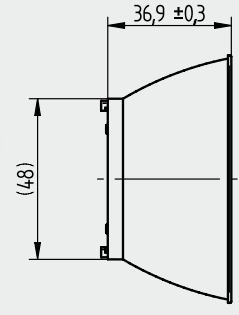
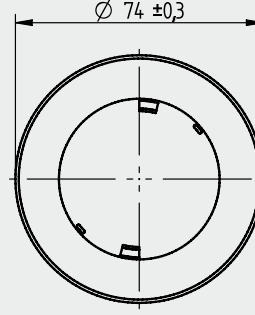
			pkg.	wt.	part no.
			1	8 g	<b>47.950.-303.56</b>



**Reflector**  
 For use with Spotlight connectors 47.319.2xxx and Spot-, Downlight modules 32.120.xxxx  
 Beam angle characteristic: Flood

- Reflector can only be used by screw fixing the spotlight connector with dome headed screws and locking washer

CAD

i  
[06] 3...

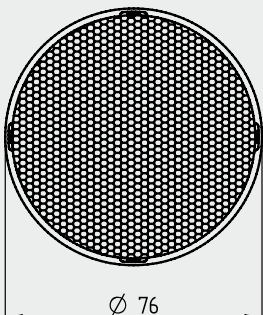
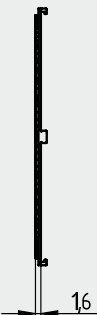





pkg.	wt.	part no.
1	3 g	<b>47.950.-401.85</b>

**Diffusor plate L2**  
For use with reflectors 47.950.-30x with Ø 50mm

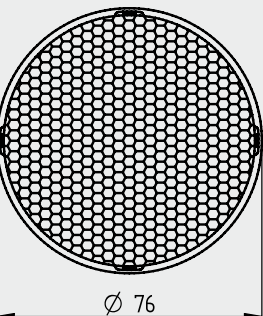
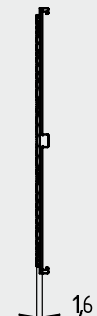

CAD   
[06] 3...



pkg.	wt.	part no.
1	3 g	<b>47.950.-402.85</b>

**Diffusor plate L6**  
For use with reflectors 47.950.-30x with Ø 50mm

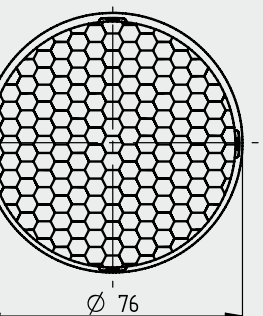
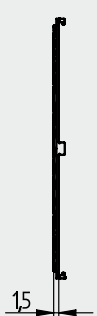
CAD   
[06] 3...



pkg.	wt.	part no.
1	3 g	<b>47.950.-403.85</b>

**Diffusor plate L12F**  
For use with reflectors 47.950.-30x with Ø 50mm

CAD   
[06] 3...

## LED - Lighting and connection technology

47.950

Reflectors for Spotlight connector series



pkg.	wt.	part no.
1	3 g	<b>47.950.-404.85</b>

### Diffusor plate oval

For use with reflectors 47.950.-30x with Ø 50mm

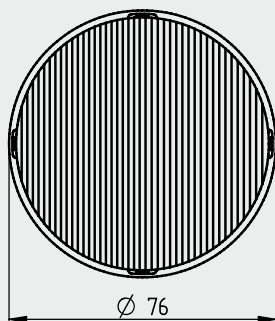
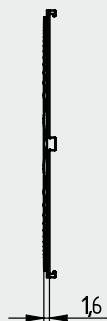

CAD

i

[06] 3...

# LED - Lighting and connection technology

## General information



All articles in this catalogue have been designed according to the appropriate national and international standards (VDE / IEC). The choice of product and correct technical embodiment is the sole responsibility of the user. Exact information can be obtained upon request. We reserve the right to modify products.

### Explanation of the symbols shown on the product pages.



**LED connector**



#### **Temperature rating T 110**

The maximum operating temperature is given by a T marking. This is the maximum operating temperature for which the product is designed.

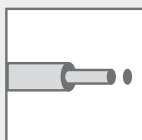

**Single push wire terminals**

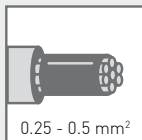

#### **For tinned wire ends within the cross sectional range stated**

(In this example 0.25 - 0.5 mm<sup>2</sup>)  
When regulations deviate from IEC, other cross sections are possible (e.g. UL / CSA: cable 18 AWG).

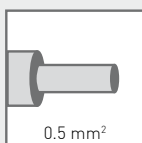

#### **For solid conductors within the cross sectional range stated**

(In this example 0.5 mm<sup>2</sup>)  
When regulations deviate from IEC, other cross sections are possible (e. g. UL / CSA: cable 18 AWG).



**CAD-Data in 2D or 3D format available**



#### **Additional information**

Further information about the products shown on this page can be found on the pages shown within this symbol.

BJB GmbH & Co. KG · Werler Str. 1 · 59755 Arnsberg · Germany  
Telefon +49 2932 982-0 · Fax +49 2932 982-8201  
info@bjb.com · www.bjb.com



Your Connection to Light